

SKIMZ  
SUMPRO | SPECIFICATIONS

Model	Dimensions	Skimmer Chamber	Centre/Refugium Chamber	Return Chamber	Skimmer Water Level
UP14	L14" x W18" x H15" 356 X 457 X 381mm	8" x 13" 204 x 331mm	-	5" x 17" 134 x 445mm	7" - 9" 180 - 230mm
UP18	L18" x W18" x H15" 457 X 457 X 381mm	12" x 13" 305 x 331mm	-	5" x 17" 134 x 445mm	7" - 9" 180 - 230mm
UP21	L21" x W18" x H15" 533 X 457 X 381mm	11.5" x 13" 293 x 331mm	-	5" x 17" 134 x 445mm	7" - 9" 180 - 230mm
UP22	L22" x W12" x H15" 559 X 305 X 381mm	11.5" x 11" 293 x 293mm	-	5" x 12" 134 x 293mm	7" - 9" 180 - 230mm
UP30	L30" x W15" x H15" 762 X 381 X 383mm	14" x 14" 362 x 365mm	-	8" x 14" 202 x 365mm	7" - 9" 180 - 230mm
UP34	L34" x W15" x H15" 864 X 381 X 383mm	13" x 14" 326 x 365mm	5" x 14" 122 x 365mm	8" x 14" 202 x 365mm	7" - 9" 180 - 230mm
UP36	L36" x W15" x H15" 914 X 381 X 383mm	13" x 14" 326 x 365mm	6" x 14" 162 x 365mm	8" x 14" 202 x 365mm	7" - 9" 180 - 230mm
UP39	L39" x W15" x H15" 991 X 381 X 383mm	14" x 14" 343 x 365mm	8" x 14" 212 x 365mm	8" x 14" 202 x 365mm	7" - 9" 180 - 230mm

SKIMZ  
SUMPRO | FEATURES

Model	Duoflo Sock Chamber	Level-o-matic	Probe Holders (4)	Tube Holders (4)	Top-up Reservoir (gal / litre)	Sock 4" L9.45"	Sock 4" L14"	Total Water Volume (gal / litre)
UP14	-	✓	✓	✓	-	-	1	15 / 56
UP18	✓	✓	✓	✓	-	1	1	19 / 73
UP21	✓	✓	✓	✓	3.2 / 12	1	1	22 / 85
UP22	✓	✓	✓	✓	-	1	1	16 / 59
UP30	✓	✓	✓	✓	2.0 / 7.5	1	1	27 / 101
UP34	✓	✓	✓	✓	2.4 / 9.0	1	1	30 / 114
UP36	✓	✓	✓	✓	2.7 / 10	1	1	32 / 121
UP39	✓	✓	✓	✓	3.0 / 11.5	1	2	35 / 131

## WARRANTY POLICY

AAP Marketing Pte Ltd (Company) warrants this product to the original purchaser against defective material and workmanship that occurs during normal use for two (2) years. Company will, at Company's option, either repair or replace without charge.

## PRODUCTS COVERED BY WARRANTY

All Skimz equipment is covered by warranty from the date of purchase. To be effective, register your product at: [www.skimz.sg](http://www.skimz.sg), product warranty within 14 days of the product's purchase date.

## Exclusions:

1. Damage resulting from accident, misuse, lack of reasonable care, subjecting the product to abnormal working conditions or any other failure not resulting from defects in materials or workmanship.
2. Damage caused by tampering, modification or attempted repair by anyone other than the Company.
3. Transfer of product to someone other than the original purchaser.

Bring the product to your nearest Skimz dealer or ship the product, together with a copy of the purchase receipt or other evidence of purchase to:

**AAP Marketing Pte Ltd**  
5 Ang Mo Kio Industrial Park 2A  
#04-30 AMK Tech II  
Singapore 567760

You must pay any postage, shipping charges, insurance costs and other expenses to return the product to AAP. However, if the necessary repairs are covered by the warranty, Company will pay the return shipping charges.

## QUICK INSTALLATION GUIDE

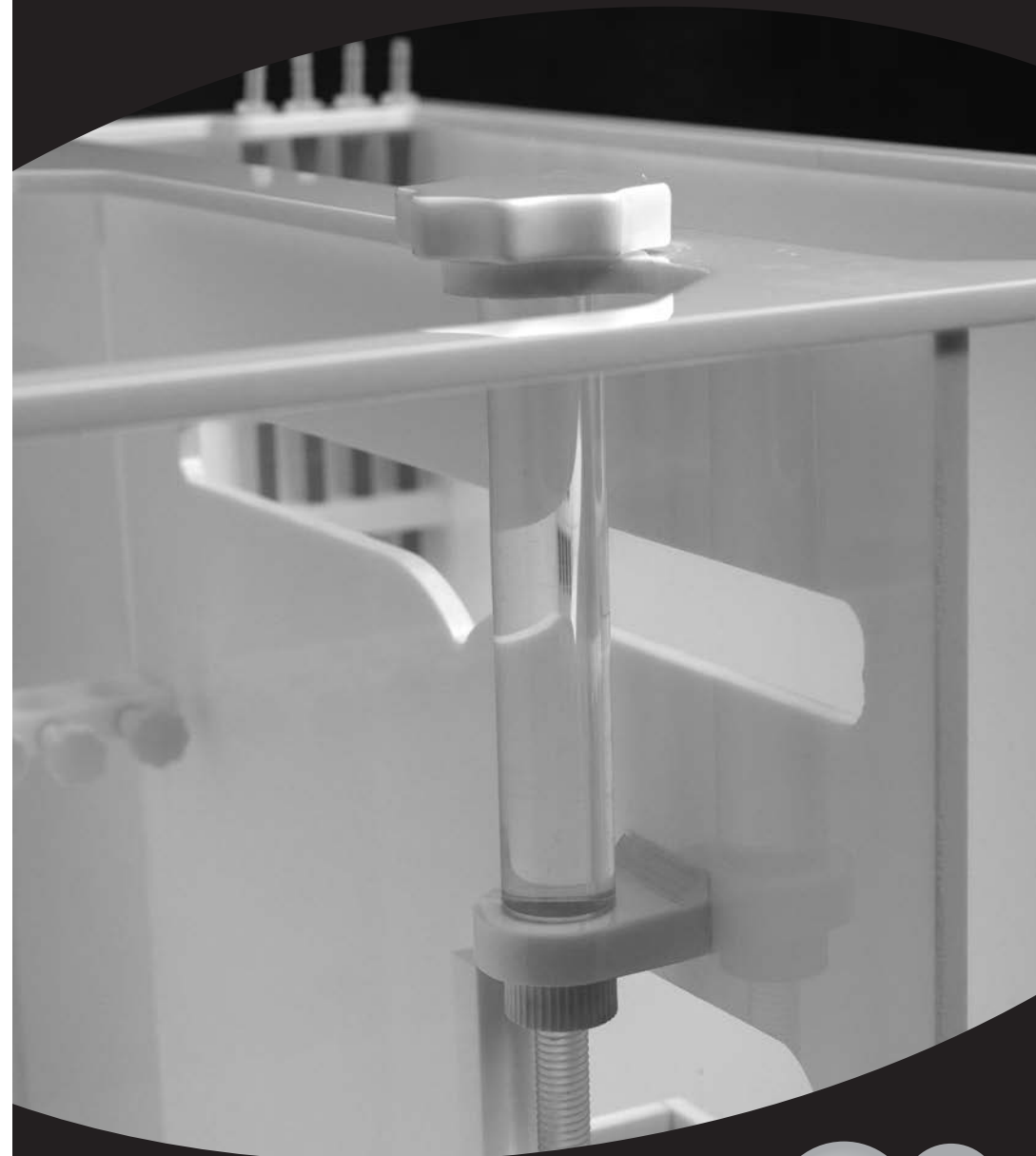

**Sumpro Sump Tank**  
UP14 • UP18 • UP21 • UP22 • UP30 • UP34 • UP36 • UP39



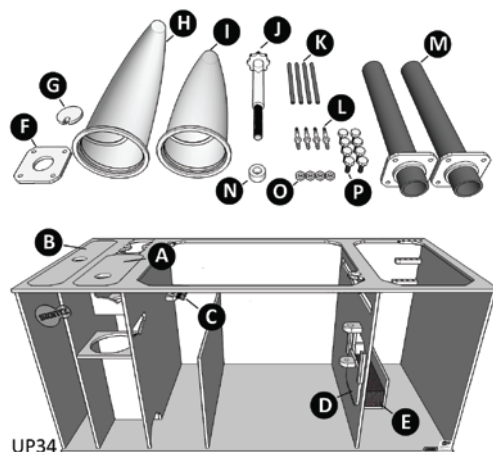

- A. Sock cover
- B. Top-up reservoir cover  
(applicable to UP21, UP30 to UP39)
- C. Probe holder thumbscrews
- D. Spillway gate
- E. Sponge
- F. Chiller hose cover
- G. Heater cover plate
- H. EL-M300 sock
- I. EL-S300 sock (not included for UP14)
- J. Lever-o-matic control knob
- K. 6mm silicon tubing
- L. Tubing hose barbs
- M. Switchable PVC pipe cover  
(UP14 to UP22 - 1pc, UP30 to UP39 - 2pcs)
- N. Level-o-matic locking nut
- O. Hose barb nuts
- P. Switchable cover thumbscrews  
(UP14 to UP22 - 4pcs, UP30 to UP39 - 8pcs)

### STEP 1

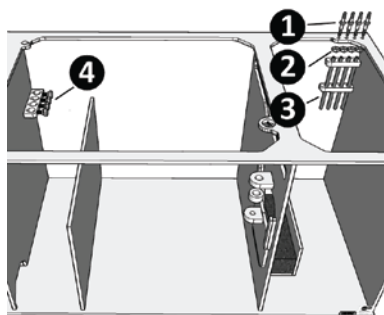

1. Insert the tubing hose barb into the tube holder on the top support brace.
2. Secure the tubing hose barbs with the hose barb nuts.
3. Connect the silicon tubing to the tubing hose barb.
4. Insert the thumbscrew into the probe holder, and tighten the thumbscrew to secure the probe.

### STEP 2

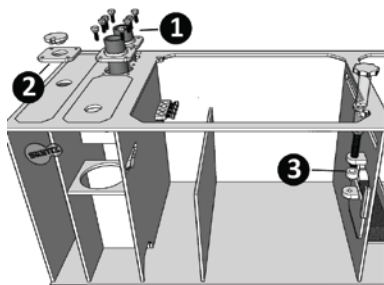

1. Insert the switchable PVC pipe cover, and tighten it with the thumbscrews.
2. You can replace one of the switchable PVC cover with chiller hose cover and heater cover plate. Not applicable to UP14 to UP22.
3. Insert the Level-o-matic control knob into the guide hole through the guide plate.
4. Tighten the level-o-matic locking nut below the guide plate.
5. Connect the level-o-matic control knob to the spillway gate.

### STEP 3

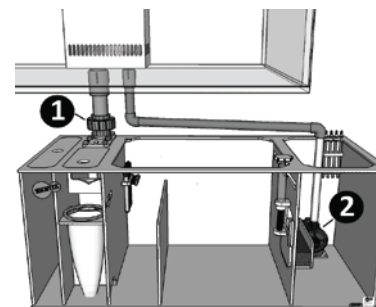

1. Connect a PVC union (not supplied) to the switchable pipework and link with the water outlet of the main tank.
2. Connect the return pump (not supplied) with the main tank return pipework.

### STEP 4

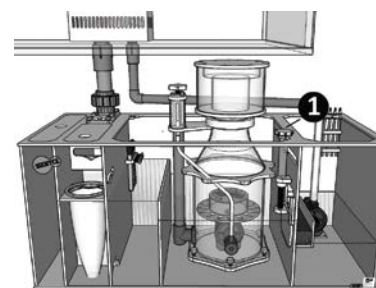

1. Power up the return pump (not supplied) and adjust the water level according to desired level according to skimmer operating level.
2. Water level in the skimmer chamber is adjustable from 180 to 230mm.

### STEP 5

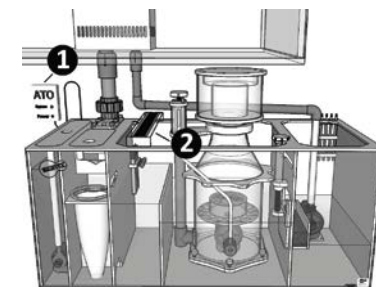

1. For models UP21 and UP30 to UP39, a small water pump should be connected to an ATO for water top up operation.
2. For models UP30 and above, suitable lightings (not supplied) should be installed when the refugium is in operation.